



CARLOS BUXADERAS RIEROLA

REPUESTOS TEXTILES

Calle de la Carena, 103 (Buzón 293)
08251 Castellnou de Bages
Barcelona
España

Tel: 34 936 883 654
Cel: 34 639 769 528
carlosbuxaderas@gmail.com
NIF: 39331551X



REPUESTOS TEXTILES FIBRA LARGA

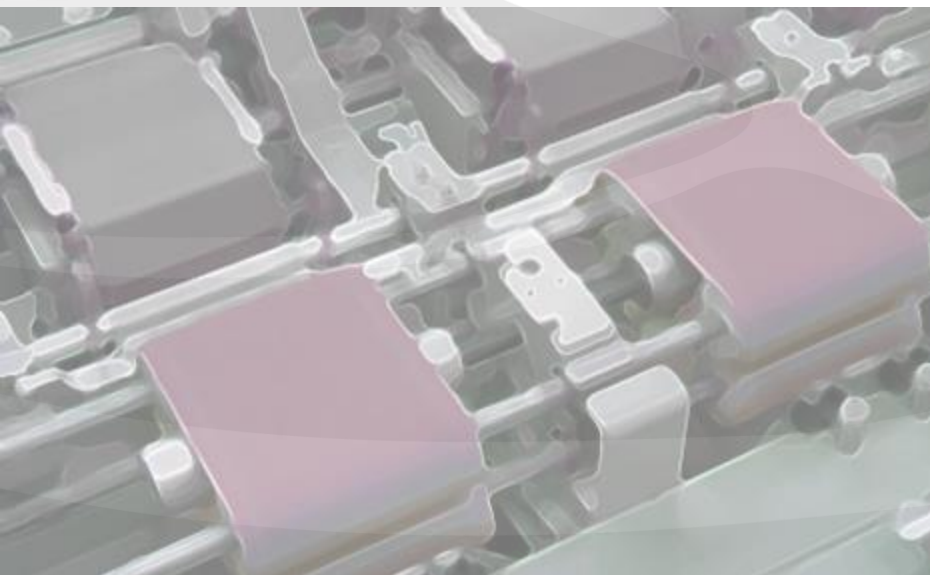



REPUESTOS PARA PEREPARACION

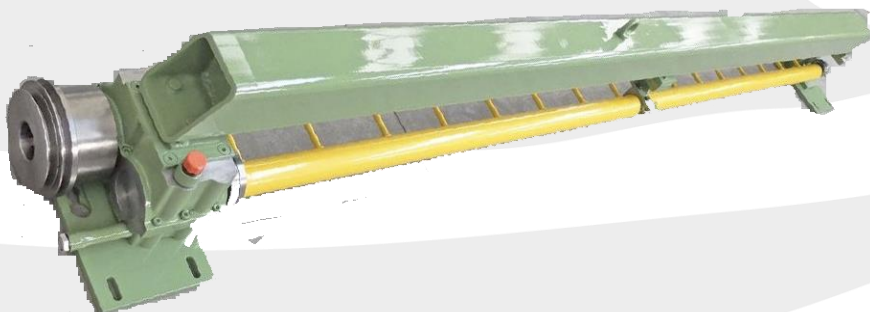
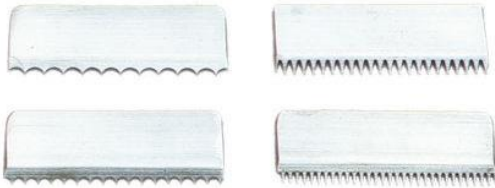
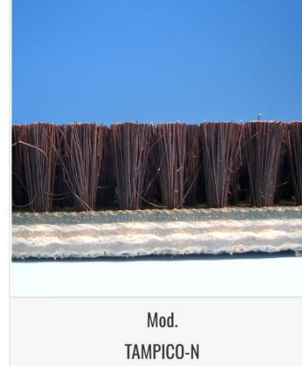
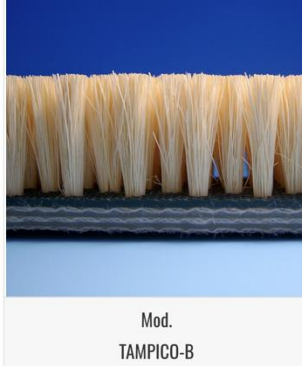



REPUESTOS PARA PASAJES NSC GN Y GC



ANILLOS COILER

KOD	EXPLANATION
425A030H	Ring Wire DIA 457,05
425A031K	Ring Wire DIA 482,95
425A037Z	Ring Wire DIA 372,95
425A038B	Ring Wire DIA 347,05
425A034S	Ring Wire 307,05
425A035V	Ring Wire 332,95

KOD	EXPLANATION
425A040J	Ring Wire OUT DIA 282,95
425A041L	Ring Wire 257,05
425A044T	Ring Wire DIA 227,95
425A045W	Ring Wire DIA 202,05
425A046Y	Ring Wire 152,05
425A048C	Ring Wire 177,95
425A231H	Tape KK 100K 9,525 mm





MEMORIA



GN19187AJ



GN19188AW



COTS



SINFINES MARTILLOS BUJES GN 5- 6

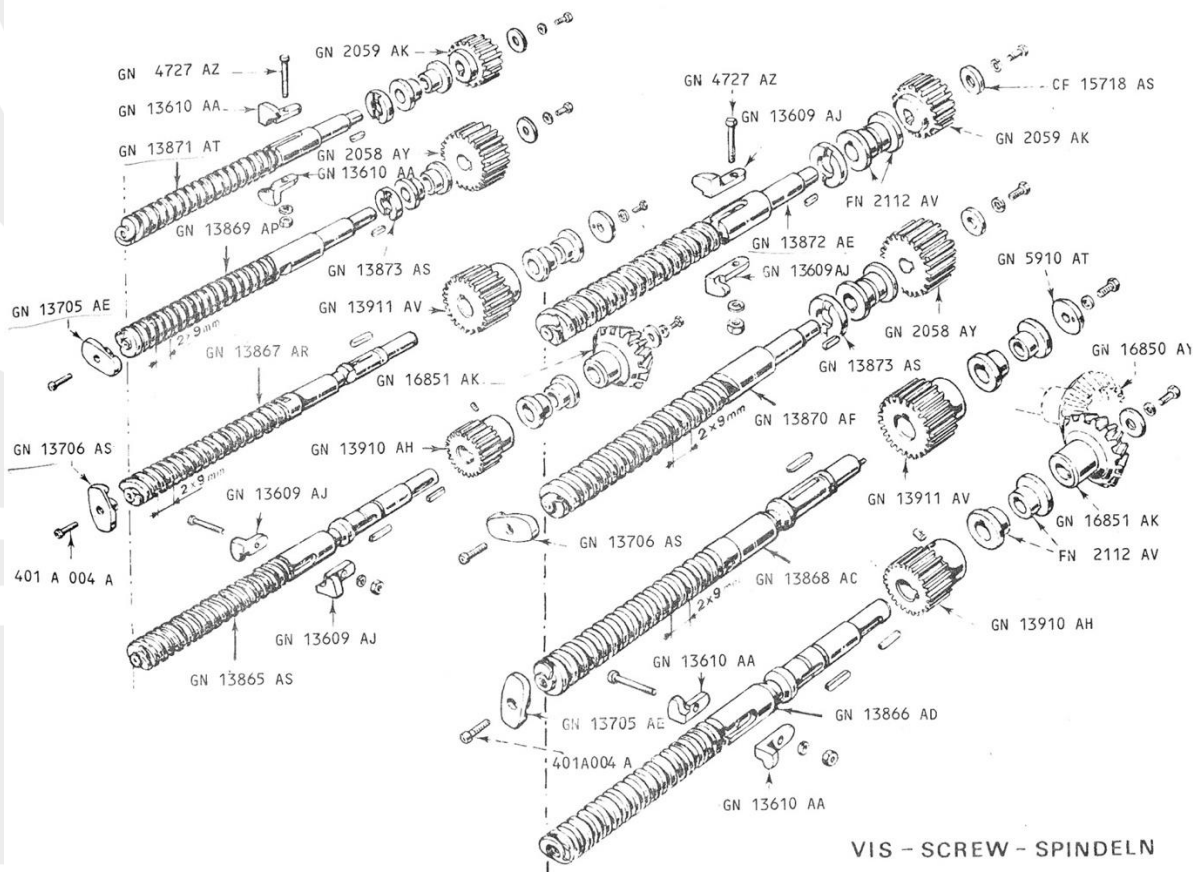



CARLOS BUXADERAS RIEROLA

REPUESTOS TEXTILES

Calle de la Carena, 103 (Buzón 293)
08251 Castellnou de Bages
Barcelona
España

Tel: 34 936 883 654
Cel: 34 639 769 528
carlosbuxaderas@gmail.com
NIF: 39331551X





CADENA, GUIAS Y PEINES



432A152M



GN18595AX

PEINES PARA NSC GC

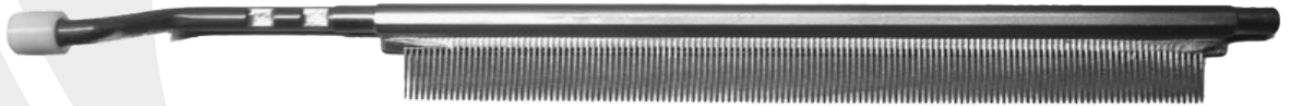

MEDIDAS	CAMPO	ALTURA
13,5X332	220	14
17,5X332	220	14
13,5X382	270	14
17,5X382	270	14

PEINES E INSERTOS PARA NSC GN



	MEDIDAS	CAMPO	ALTURA
GN4	320X28X6	220	17,5
GN 5 -6	320X23X6	220	17,5



PEINES PARA SANT'ANDREA CSN

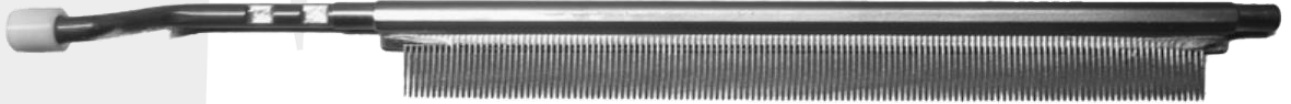

MEDIDAS	CAMPO	ALTURA
332X13,5	220	14
332X17,5	220	11

PEINES PARA SANT'ANDREA SEUP VSN P.9 P.11



	MEDIDAS	CAMPO	ALTURA
SEUP VSN P.9	300X25X6,5	200	18,5
2M VSN P.11	300X25X7,2	200	18,5

PEINES PARA COGNETEX



	MEDIDAS	CAMPO	ALTURA	
SC400	328X15X5.1	228	15,25	22º
	378X15X5,6	276	15,25	22º
SC600	378X18X5.2	276	15,25	21º
SSTR	328X12X5	228	15,25	13º
	328X12X5,2	228	15,25	22º

INSERTOS PLÁSTICOS Y METALICOS





CEPILLOS



639000320



713020007



1101290 639070210



Mod.

GC-Normal-Head-Wide-Head

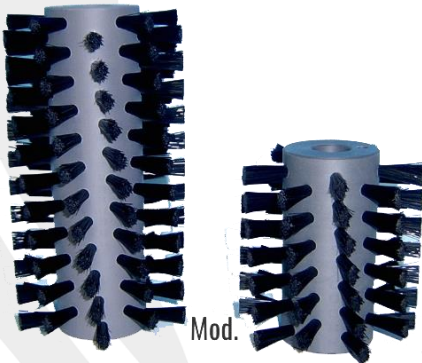

Mod.

4590041001-4590084001

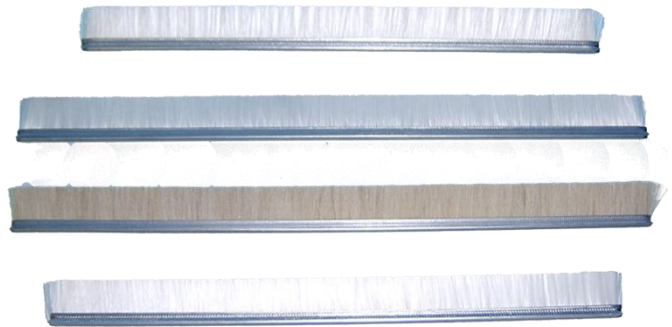

C2972707

COGNETEX SANT'ANDREA

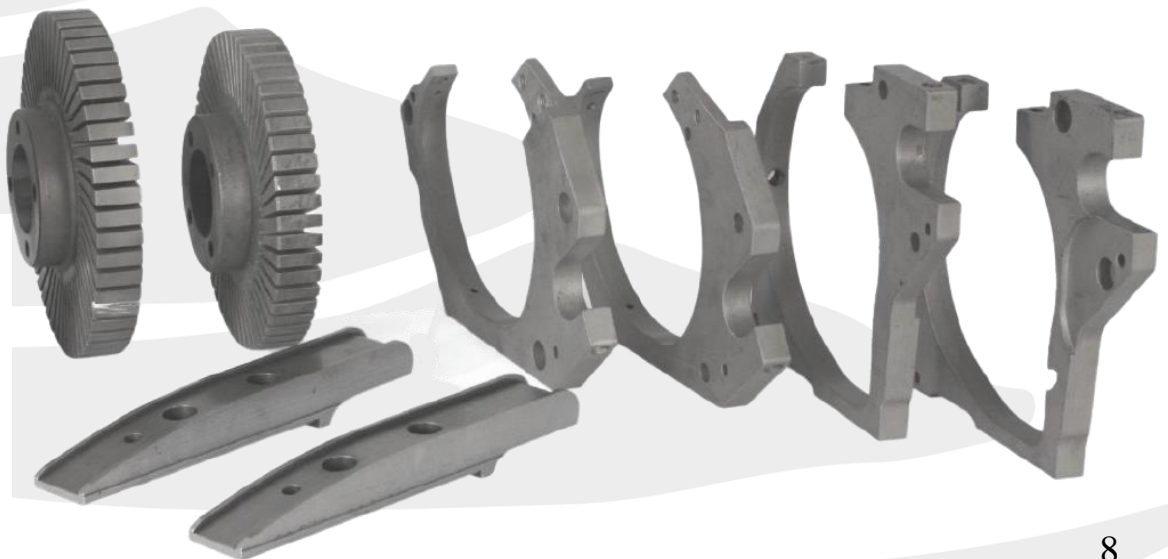



ERIZOS

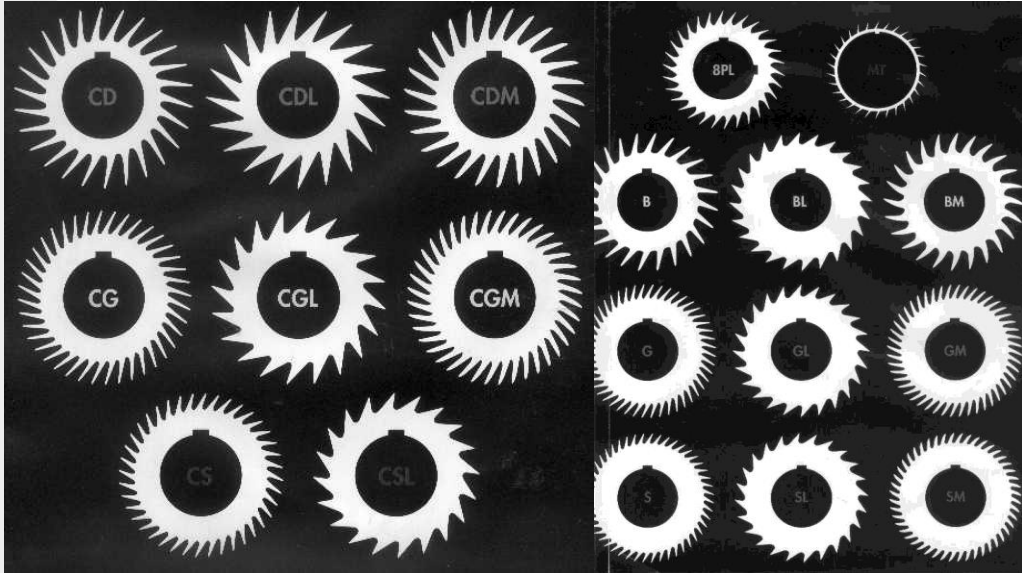

ITEM NO.	Tipo	Ø.int.	Ø.ext	Dientes	Grosor
C2238087	G	30	67	48	1
C2238088	CG	25	53	40	1
C2238086	CGL	25	53	20	1
C2238061	S	30	65	48	1
C2238062	CS	25	50	40	1
C2238060	CSL	25	50	20	1
B	B	30	70	24	1
SL	SL	30	65	24	1
BP	BP	30	60	30	0.8
CD	CD	25	55	26	1
BCD	BCD	25	55	26	0.8
BCG	BCG	25	53	40	0.8
BCS	BCS	25	50	40	0.8
CL	CL	25	55	26	1
BCL	BCL	25	55	26	0.8
CDL	CDL	25	55	20	1
BCDL	BCDL	25	55	20	0.8
BCGL	BCGL	25	53	20	0.8
BCSL	BCSL	25	50	20	0



PEINADORAS



Product number	Teeth per cm ²	Colour		Number of teeth rows
CBM.05.25.025.320	25	Orange	Black	5
CBM.10.40.049.320	49	Grey	Yellow	10
CBM.10.35.053.320	53	Yellow	Yellow	10
CBM.10.30.058.320	58	Green	Yellow	10
CBM.10.25.062.320	62	Orange	Yellow	10
CBM.12.25.088.320	88	Orange	Brown	12
CBM.12.20.097.320	97	Red	Brown	12
CBM.15.25.110.320	110	Orange	Beige	15
CBM.15.20.125.320	125	Red	Beige	15
CBM.15.15.139.320	139	Blue	Beige	15
CBM.15.15.152.320	152	Blue	Grey	15

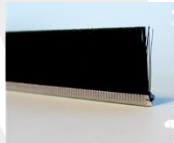

Mod.
PB40-LPB20585AH



Mod.
PB40-LPB21033AH



Mod.
PB33-PB19369AX



Mod.
PB33-PB40-PB19308AS



Mod.
PB31-PB33-PB17721AF



Mod.
PB31-PB18967AZ



Mod.
PB31-PB17722AT



Mod.
PB32-PB33-PB19236AW

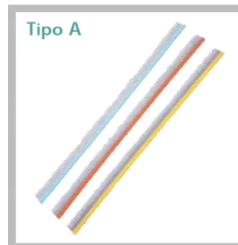

Tipo A

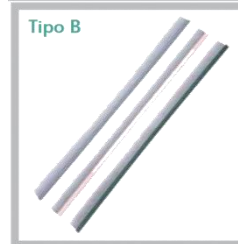
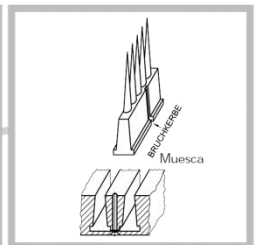

Tipo B

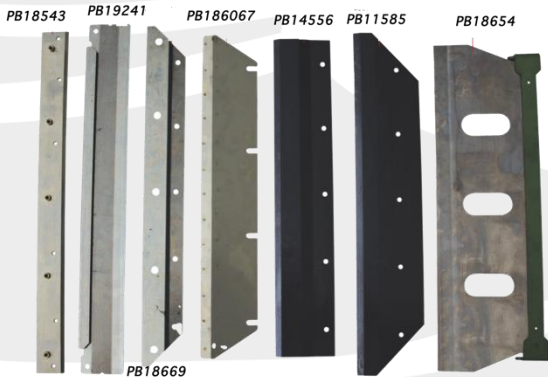
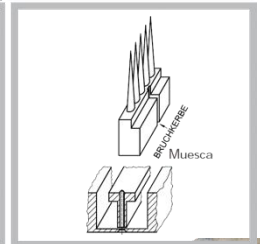

Mod.
PB16507AD

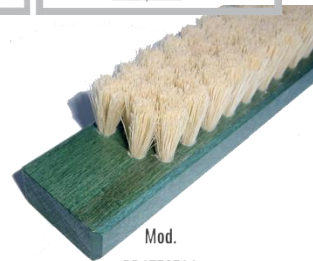

Mod.
PB15737AA

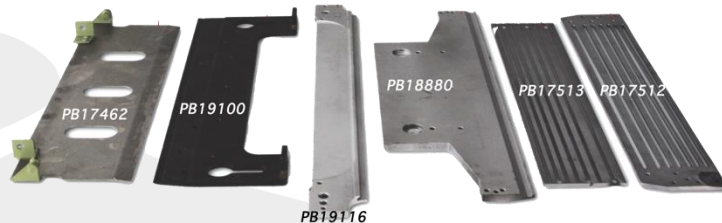



MANGAS PEINADORAS



640 x 530mm (NSC PB 27 – 31)
580 x 540mm (NSC PB 32 -34)
580 x 540mm (Sant'Andrea P 90)
580 x 520mm (Sant'Andrea P 100)

501A305P
501A346X
30736410
33319530



Negra 85ºSh superficie estriada. Se utiliza principalmente para el procesamiento de lana y fibras menos agresiva

Azul 85º Sh exterior de piel de naranja. Se utiliza principalmente para mezclas de lana, mezclas de sintéticos y sintéticos puros.

Rojo 78ºsh exterior liso. Excelente rendimiento y larga vida útil en las máquinas de peinado modernas.

Gris : Esta manga está fabricada con materiales técnicamente sofisticados y está diseñada para ofrecer un alto rendimiento.

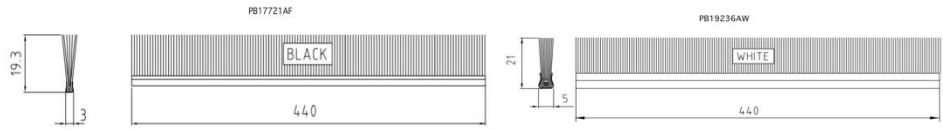

PB16512AT Cepillo nuevo modelo intercambiable, no hay que cambiar cada vez los soportes



Peine rectilíneo, densidades de 14 a 32 agujas/cm

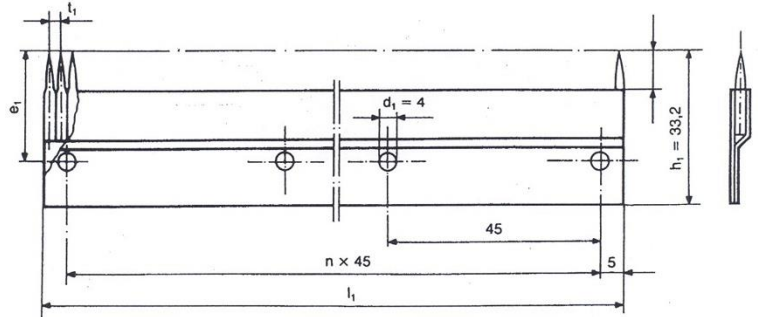

Top Comb pin strip

Pinning Density	N. Schlumberger PB26 – PB33	N. Schlumberger ERA	Sant Andrea P90	Sant Andrea P100	Textima
Pins per cm	mm	mm	mm	mm	mm
14 – 32	470	510	460	470	460
Pin Projection	mm	mm	mm	mm	mm
	8.2	8.2	8.2	8.7	8.2
	9.2	9.2	9.2	–	9.2
	10.2	10.2	10.2	–	10.2

Circular Comb pin strip

Pinning Density	Type A (thickness)	Type B (thickness)	N. Schlumberger PB26 – PB29	N. Schlumberger PB30 – PB33	Sant Andrea P90	Sant Andrea P100	Textima
agujas / cm.	mm	mm	mm	mm	mm	mm	mm
4 – 14.1	2.0	2.5	434	440	434	460	444
14.2 – 32	1.0	1.4	434	440	434	460	444

SUCO Feed Comb pin strip

Pinning Density	N. Schlumberger PB26 – PB29	N. Schlumberger PB30 – PB33	N. Schlumberger ERA	Sant Andrea P90	Sant Andrea P100
Pins/cm	mm	mm	mm	mm	mm
2 – 9.5	410	410	460	400	410
Type	A	B	B	A	B



FROTADORAS

SANT'ANDREA



45193360



453904503



453000500 453000600

COGNETEX



614300110 614300120

614300130

94 mm

100mm

100mm

NSC FM



423A009M



FN8514AY



FN9715AL



FN 15254 AM

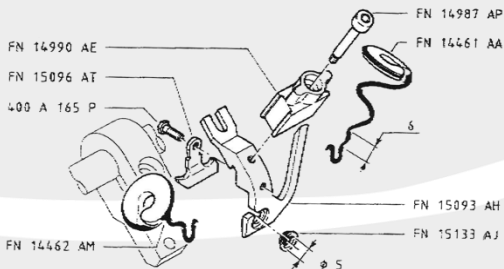

FN 14990 AE

FN 15096 AT

400 A 165 P

FN 14987 AP

FN 14461 AA

FN 15093 AH

FN 15133 AJ

FN 14462 AM

φ 5

1 453 9550001 Ø 5
2 453 93110 Dx P = 8x3 n
3 453 95530 Sx P = 8x3 n

1 453 9550001 Ø 5
2 451 97300 Dx P = 8x3 n
3 451 97310 Sx P = 8x3 n

1 453 9551001 Ø 5
2 453 96050 Dx P = 10x3 n
3 453 96060 Sx P = 10x3 n

1 453 9551001 Ø 5
2 453 96070 Dx P = 12x3 n
3 453 96080 Sx P = 12x3 n

1 453 9551001 Ø 5
2 451 98470 Dx P = 15x3 n
3 451 98480 Sx P = 15x3 n

1 453 9552001 Ø 7
2 451 98470 Dx P = 15x3 n
3 451 98480 Sx P = 15x3 n

1 453 9552001 Ø 7
2 453 96000 Dx P = 18x3 n
3 453 95010 Sx P = 18x3 n

1 453 9552001 Ø 7
2 451 97360 Dx P = 15x2 n
3 451 97370 Sx P = 15x2 n

1 453 9552001 Ø 7
2 451 97380 Dx P = 18x2 n
3 451 97380 Sx P = 18x2 n

1 453 9552001 Ø 7
2 452 93170 Dx P = 22x2 n
3 452 93180 Sx P = 22x2 n

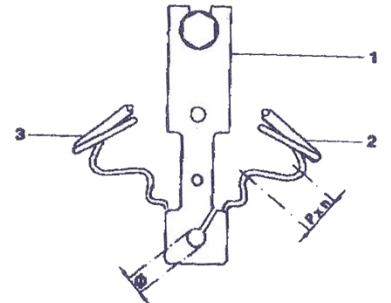



MANGAS FROTADORAS

NSC

FM7; FMV32B **501A266A** 468x166x4mm (146x160x4)
FM 4 & 5 **501A133S** 535x160x3,5mm (170X160X3,5)
501A023R 465x160x3,5mm (148X160X3,5)
501A166B 524X160X3,5 (166,2X160X3,5)
501A157C 465X160X3,5 (148X160X3,5)

Sant'Andrea

SSR/2 **2975082** 427x150x4mm
RF2 **C3299970** 459x117x4mm
RF4A/ **C3299957** 459x122x4mm
C3299971 C2975083 535X135X4

Cognetex

SRB/41 **40169998** 550x155x4mm (175X155X4)
SFG/22 **628502680** 550x170x4mm (175X170X4)
FRC300 **628503430** 527x170x4mm (168X170X4)
FRC 16/S **40169997** 535/540x170x4mm



MANGAS LISAS

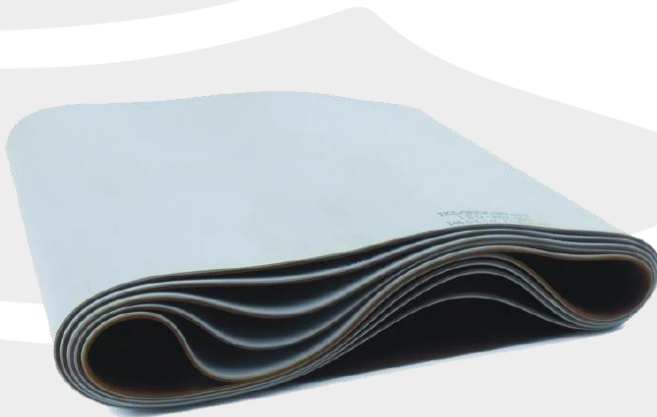

501A002L	161,93X200X1,5
501A012M	102X40X1.1
501A013P	151,5X144X1,5
501A014S	102X50X1,1
501A074Z	159 X 145X 1.6
501A076D	146.5 X 145X 1.6
501A077F	146.5X145X1.6
501A080R	159X145X1.6
501A195C	146.5x220X1.5
501A198K	161.5X160X1,5
501A283W	58.2X53X1,2
501A378E	146.5X160X1.5
501A379A	158X145X1.5





BARRILES - PORTABARRILES

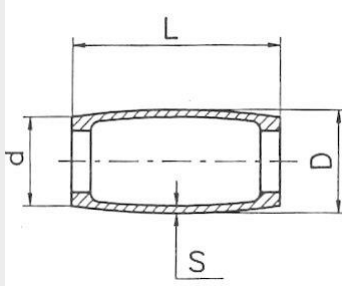

BARRILES

- 53X30 55°SH
- 68X30 60°SH
- 94X36 75°SH
- 125X36 80°SH
- 155X36

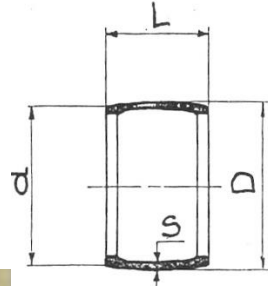

- 20X40
- 28X48,7
- 30X30
- 32X30
- 43X36

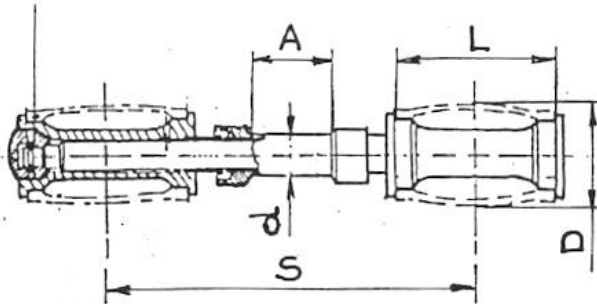

TIPO 1 RCA

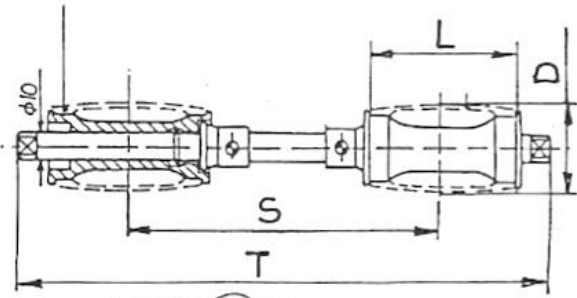

TIPO 2 PFC

		S	L	D	d	A	T	
1	09038/08	100	53	29	12,8	25,3		SAMPRE
1	09038/09	105	53	29	12,8	25,3		SAMPRE
1	09038/12	120	53	29	12,8	25,3		SAMPRE
1	09038/16	140	53	29	12,8	25,3		SAMPRE
1	09013/09	105	68	29	12,8	25,3		SAMPRE
1	09013/12	120	68	29	12,8	25,3		SAMPRE
1	09013/16	140	68	29	12,8	25,3		SAMPRE
1	09013/20	160	68	29	12,8	25,3		SAMPRE
1	08248/00	120	53	29	12,8	30,3		SAMPRE
1	09540/00	130	53	29	12,8	30,3		SAMPRE
1	09564/12	120	68	29	12,8	30,3		SAMPRE
1	09564/14	130	68	29	12,8	30,3		SAMPRE
1	09564/20	160	68	29	12,8	30,3		SAMPRE
1	09828/10	110	68	29	12,8	28,0		SKF
1	09828/12	120	68	29	12,8	28,0		SKF
2	06898/03	85	68	29			176,50	COGNETEX
2	06898/04	90	68	29			181,50	COGNETEX



ELEMENTOS PARA CONTINUAS



Banditas Diámetro x ancho x grosor
Cots Diam. Int x diam. Ext. X ancho



Cots con ranura para cilindros portabanditas



Type -A-



Type -B-



Type -BB-



Type -CSB-

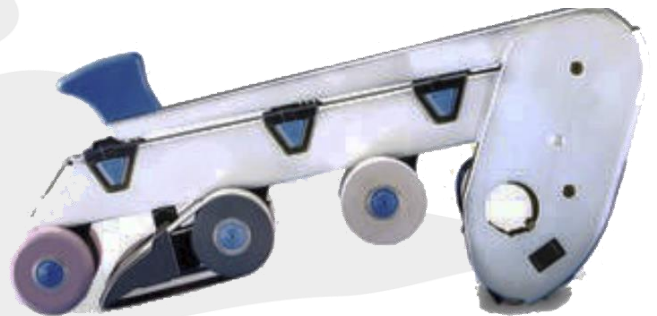

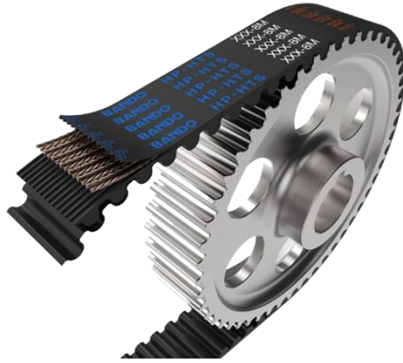

AR 5024



AR 5047



AR 3528



CARLOS BUXADERAS RIEROLA

REPUESTOS TEXTILES

Calle de la Carena, 103 (Buzón 293)
08251 Castellnou de Bages
Barcelona
España

Tel: 34 936 883 654
Cel: 34 639 769 528
carlosbuxaderas@gmail.com
NIF: 39331551X

CONDENSADORES Y CURSORES

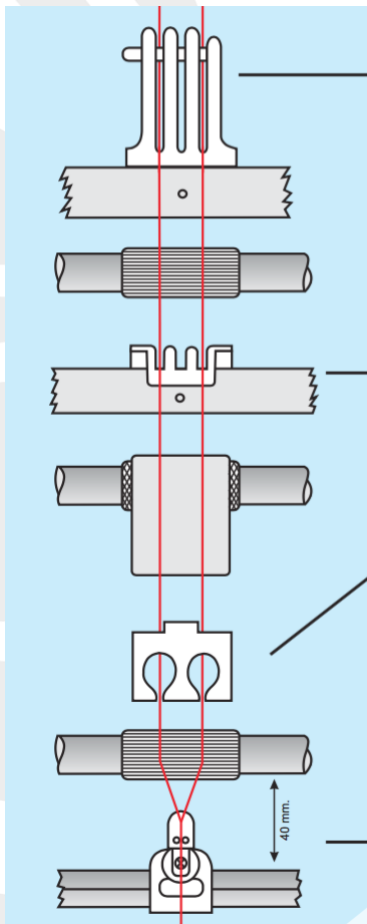
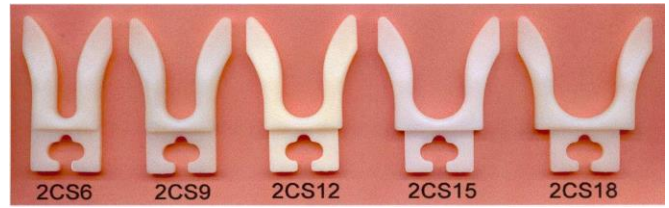
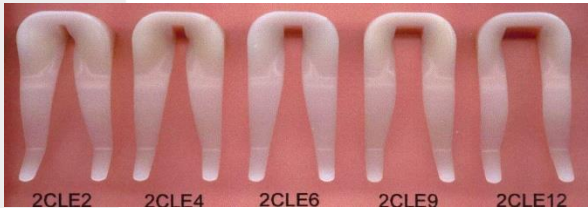
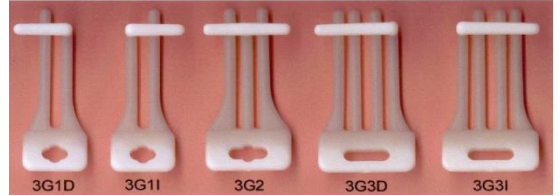
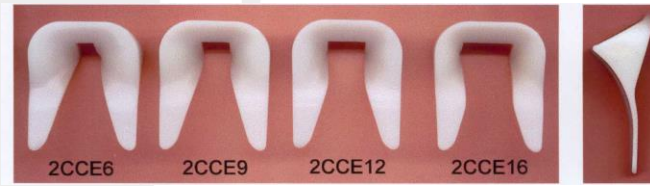

altura aro	C	ANTIPAJA	R	POLYMER	J	L	FANTASÍA	KM	ring depth
6,35 mm.									1/4"
7,5 mm. y 8mm.									19/64" y 5/16"
9,1 mm.									23/64"
9,5 mm.									3/8"
11,1 mm.									7/16"
16,7 mm.									21/32"
17,1 mm.									43/64"
17,1 mm. y 17,4 mm.									43/64" y 11/16"
25,4 mm.									1"



CINTA DE HUSOS

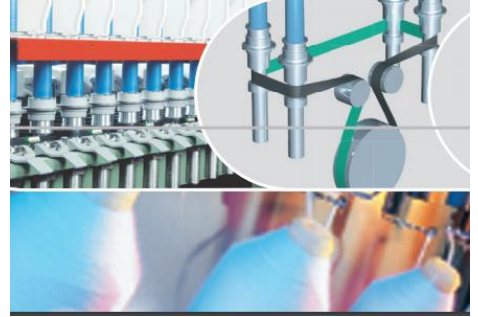

ESMERILADORA



Fixed width



Adjustable width

GUIAS



PINZA PEGADO



CERAMICAS

BANDAS

TANGENCIALES

TC- Polyester (PET) belts	TF- Aramide (AR) belts	S- Polyamide (PA) belts
------------------------------	---------------------------	----------------------------

Belt cross section

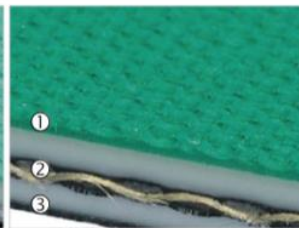
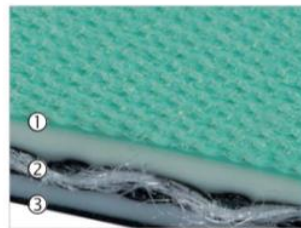



ZINSER





COGNETEX GAUDINO y LEZZENI

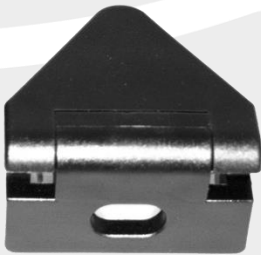



CARLOS BUXADERAS RIEROLA

REPUESTOS TEXTILES

Calle de la Carena, 103 (Buzón 293)
08251 Castellnou de Bages
Barcelona
España

Tel: 34 936 883 654
Cel: 34 639 769 528
carlosbuxaderas@gmail.com
NIF: 39331551X

SOPORTES

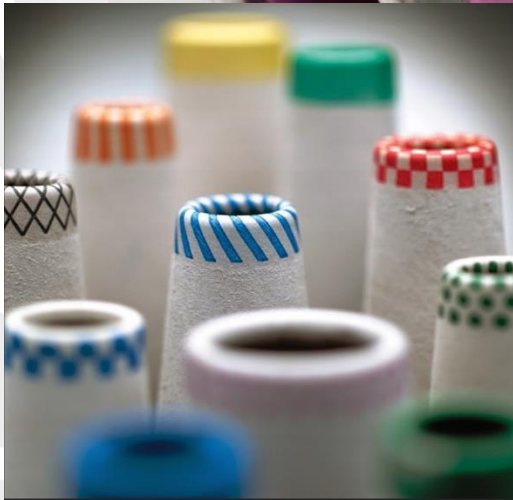



SCHLAFHORST





CARLOS BUXADERAS RIEROLA

REPUESTOS TEXTILES

Calle de la Carena, 103 (Buzón 293)
08251 Castellnou de Bages
Barcelona
España

Tel: 34 936 883 654
Cel: 34 639 769 528
carlosbuxaderas@gmail.com
NIF: 39331551X

MURATA

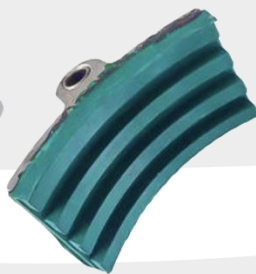



CARLOS BUXADERAS RIEROLA

REPUESTOS TEXTILES

Calle de la Carena, 103 (Buzón 293)
08251 Castellnou de Bages
Barcelona
España

Tel: 34 936 883 654
Cel: 34 639 769 528
carlosbuxaderas@gmail.com
NIF: 39331551X

REUNIDORAS Y DOBLE TORSION VOLKMANN - SAVIO





DEVANADORAS Y REUNIDORAS



FIG. 21 - A



HIGROMETROS

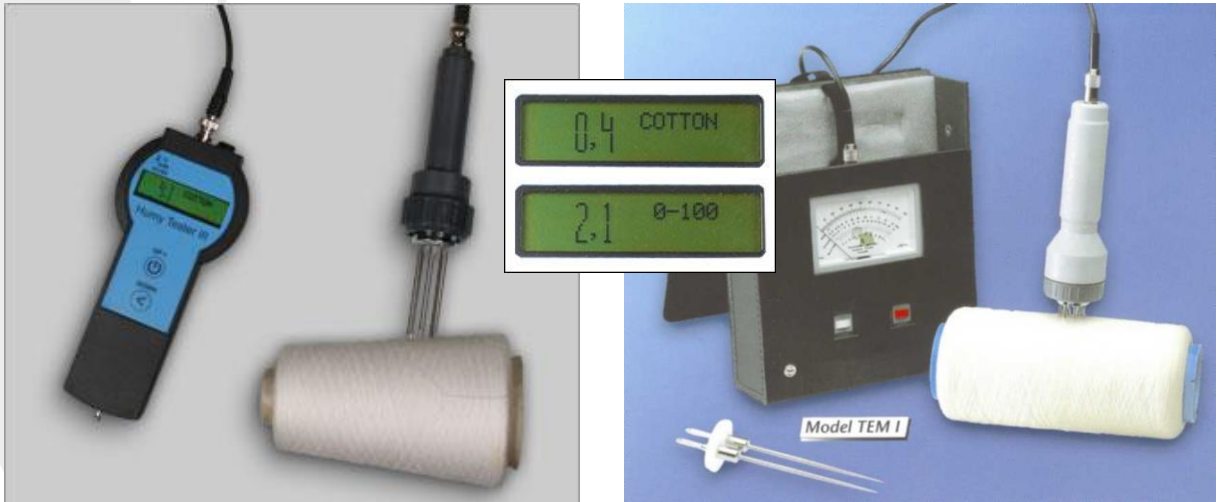

TACOMETROS



Nuevo YS-20

medidor de velocidad de hilado





TENSIOMETROS

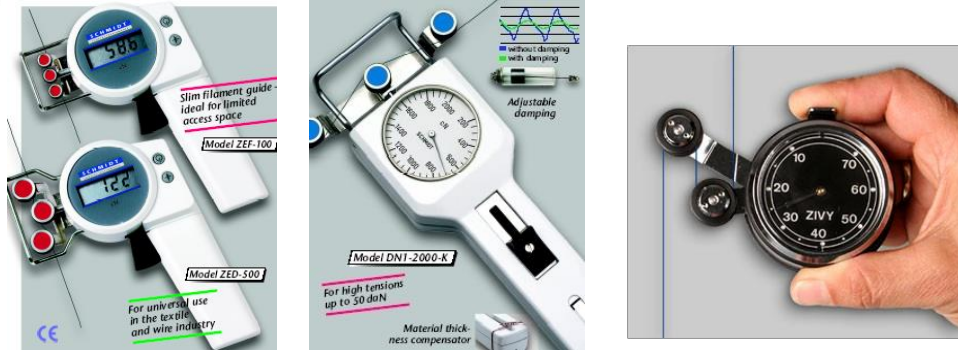

DUROMETROS

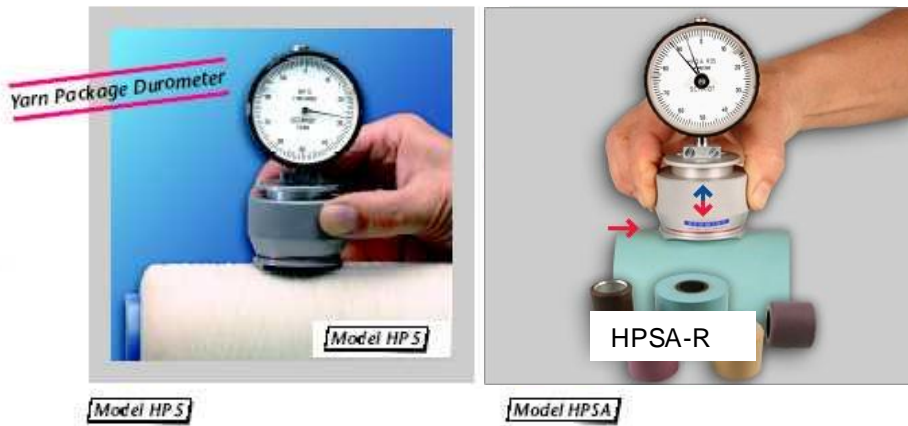

ESTROBOSCOPIO





CARLOS BUADERAS RIEROLA

REPUESTOS TEXTILES

Calle de la Carena, 103 (Buzón 293)
08251 Castellnou de Bages
Barcelona
España

Tel: 34 936 883 654
Cel: 34 639 769 528
carlosbuxaderas@gmail.com
NIF: 39331551X

TRANSMISION DE POTENCIA



DENTADO SIMPLE "T"

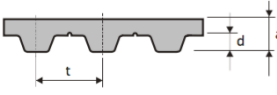

DOBLE DENTADO "T - DL"

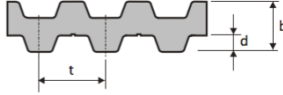

DENTADO SIMPLE "AT"

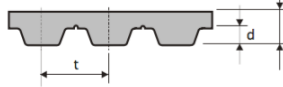

DIMENSIONES

PERFIL	M	T2	T2,5	T5	T10	T20
t= paso mm.	2,032	2	2,5	5	10	20
a=altura total	1,15	1,1	1,3	2,2	4,5	8,0
d=altura diente	0,51	0,5	0,7	1,2	2,5	5,0
b=altura total (DL)			2,0	3,4	7,0	13,0

DIMENSIONES

PERFIL	AT3	AT5	AT10	AT20
t= paso mm.	3	5	10	20
a=altura total	1,9	2,7	5,0	9,0
d=altura diente	1,1	1,2	2,5	5,0

REF.	PASO (mm)	PERFIL DENTADO SIMPLE	PERFIL DOBLE DENTADO
S3M	3		
S4,5M	4,5		
S5M	5		
S8M	8		
S14M	14		

REF.	PASO (mm)	FALCON Pd
8GTR	8	 Anchos standard (mm) 12 - 21 - 36 - 62
14GTR	14	 Anchos standard (mm) 20 - 37 - 68 - 90 - 125

REF.	PASO (mm)	PERFIL DENTADO SIMPLE	PERFIL DOBLE DENTADO
3M	3		
5M	5		
8M	8		
14M	14		

REF.	PASO		PERFIL DENTADO SIMPLE	PERFIL DOBLE DENTADO
	(mm)	Pulgadas		
MXL	2,032	2/25" (0,080")		
XL	5,08	1/5" (0,200")		
L	9,525	3/8" (0,375")		
H	12,7	1/2" (0,500")		
XH	22,225	7/8" (0,875")		
XXH	31,75	1,1/4" (1,250")		

REFERENCIA	PASO (mm)	POLY-V STANDARD
J	2,34	
K	3,56	
L	4,7	
M	9,4	

13 x 6	22 x 8	28 x 8	33 x 9	37 x 10
42 x 11	46 x 12	55 x 16	70 x 20	



DESARROLLO	AA	BB	CC
La = desarrollo exterior	Lw+31	Lw+41	Lw+53
Lw = desarrollo primitivo	s/tabla	s/tabla	s/tabla
Li = desarrollo interior	Lw-31	Lw-41	Lw-53

DESARROLLO	ZX	AX	BX	CX	DX
La = desarrollo exterior	Lw+16	Lw+20	Lw+26	Lw+36	Lw+51
Lw = desarrollo primitivo	s/tabla	s/tabla	s/tabla	s/tabla	s/tabla
Li = desarrollo interior	Lw-22	Lw-30	Lw-43	Lw-52	Lw-75

DESARROLLO	SPZ/SPZX	SPA/SPAX	SPB/SPBX	SPC/SPCX
La = desarrollo exterior	Lw+13	Lw+18	Lw+22	Lw+30
Lw = desarrollo primitivo	s/tabla	s/tabla	s/tabla	s/tabla
Li = desarrollo interior	Lw-38	Lw-45	Lw-60	Lw-83

DESARROLLO	Z	A	B	C	D	E
La = desarrollo exterior	Li+38	Li+50	Li+69	Li+88	Li+126	Li+157
Lw = desarrollo primitivo	Li+22	Li+30	Li+43	Li+52	Li+75	Li+82
Li = desarrollo interior	s/tabla	s/tabla	s/tabla	s/tabla	s/tabla	s/tabla

DESARROLLO	3VX / 3V	5VX / 5V	8V
La = desarrollo exterior	s/tabla	S/tabla	s/tabla
Lw = desarrollo primitivo	La-4	La-11	La-120
Li = desarrollo interior	La-42	La-71	

Rodamientos, cardanes, ruedas libres, cadenas

